

1.02 Hydromechanical wedge-type clamping element for placement on baseplates



Hydromechanical wedge-type clamping element for clamping forging dies, dieholder cassettes, trimming, punching and calibrating tools

- Universally usable hydromechanical wedge-type clamping element for clamping forging dies, dieholder cassettes, trimming, punching and calibrating tools, for placement on baseplates.
- Special, robust construction for use under the particularly high demands in the field of massive forming, i.e. highly resistant to mechanical, thermal and chemical loads.
- Series and variant design: different sizes, shapes and clamping forces for use in 5 MN to 80 MN presses.
- Clamping element housing and clamping piston shape can be adapted to special requirements.
- Advanced work safety thanks to hydromechanics (mechanical clamping - hydraulic releasing), self-locking of the clamping piston and the option of an electrical or hydraulic clamping piston position inquiry.

→ Components

→ Products

→ Range of Products and Services

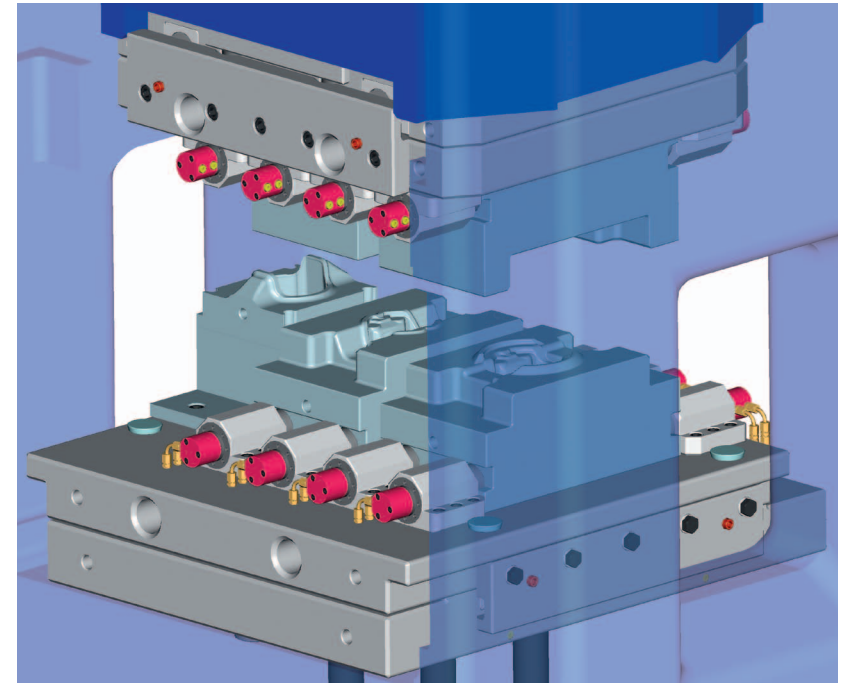

Hydromechanical wedge-type clamping elements for clamping rectangular forging dies in a cassette of a Fellner combined forging die/cassette quick-change system for a 25 MN drop forging eccentric press (view from front right top)

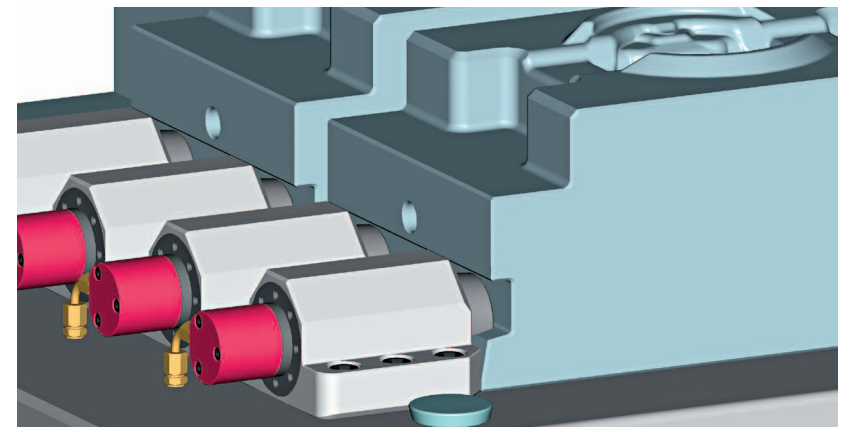

Detail from picture above: rectangular forging die clamping situation (view from front right)